

# Steam Station

## User Manual



SGA7126P  
SGA7124B

EN | DE | FR | TR | ES  
PL | HR | RO | IT | TH

01M-8834133200-5017-06  
01M-8834593200-5017-06

**beko**

# Please read this manual first!

Dear Customer,

Thank you for preferring this Beko product. We hope that you get the best results from your product which has been manufactured with high quality and state-of-the-art technology. Therefore, please read this user manual and all other accompanying documents carefully before using the product and keep it as a reference for future use. If you handover the product to someone else, give the user manual as well. Follow all warnings and information in the user manual.

## Meanings of the symbols

Following symbols are used in the various sections of this manual:



Important information and useful hints about usage.



**WARNING:** Warnings against dangerous situations concerning the security of life and property.



APPAREL CARE

The wool cycle of this iron has been approved by The Woolmark Company for the ironing of pure wool products provided that the products are ironed according to the instructions on the garment label and those issued by the manufacturer of this iron.  
R0000

The Woolmark symbol is a Certification mark in many countries.



This product has been manufactured in environmental friendly modern plants without giving any harm to the nature.



It does not contain PCB.  
Made in : P.R.C.

# CONTENTS

ENGLISH	5-13
DEUTSCH	14-27
FRANÇAIS	28-40
TÜRKÇE	41-51
ESPAÑOL	52-65
POLSKI	66-81
HRVATSKI	82-92
ROMÂNĂ	93-107
ITALIANO	108-121
ไทย	122-133

# 1 Important safety and environmental instructions

This section contains safety instructions that will help protect from risk of personal injury or material damage.

Failure to follow these instructions invalidates the granted warranty.

## 1.1 General safety

- This appliance complies with the international safety standards.
- This appliance can be used the children who are at the age of 8 and above and by people who have limited physical, sensory or mental capacity or who do not have knowledge and experience, provided that they are supervised or they understand the instructions with regard to safe use of the product and potential dangers. Children should not play with the appliance. Cleaning and user maintenance procedures should not be performed by children unless they are supervised by an older person.
- Do not leave the appliance unattended while it is plugged in.
- Unplug the appliance before filling the water reservoir with water.
- Do not open the water refill hole during usage.
- Operate and store the appliance on a stable surface.
- When the appliance is placed on its base plate, ensure that the surface beneath the plate is level.
- Always rest your iron on the base.
- If the appliance is dropped or leaks water or has other failures, contact the authorised service. Do not use the appliance until it is repaired.
- When the appliance is in use or left to cool down, keep the appliance and power cable out of reach of children under 8 years old.
- The appliance is not suitable for outdoor use.
- Only use the original parts or parts recommended by the manufacturer.
- Use the appliance only when it is connected to the steam iron station.

# 1 Important safety and environmental instructions

- Do not dismantle the appliance.
- Your mains power supply should comply with the information supplied on the rating plate of the appliance.
- The mains supply of the appliance should be secured with a 16 A fuse minimum.
- Use the appliance with a grounded outlet.
- Do not use the appliance with an extension cable.
- Do not pull the power cable when unplugging the appliance.
- If the power cable is damaged, it should be repaired or replaced by the dealer, service center, or a specialised and authorised service with similar qualifications.
- Unplug the appliance before cleaning.
- Do not wrap the cable around the appliance.
- Do not touch the appliance or its plug with damp or wet hands when the appliance is plugged in.
- The soleplate and the steam station surface may get overheated. Contact with hot surfaces may cause burns.
- Do not use the appliance in or near the areas where combustible or inflammable places and materials exist.
- If you keep the packaging materials, store them out of the reach of children.

## 1.2 Compliance with WEEE Directive and Disposing of the Waste Product



This product complies with EU WEEE Directive (2012/19/EU). This product bears a classification symbol for waste electrical and electronic equipment (WEEE). This product has been manufactured with high quality parts and materials which can be reused and are suitable for recycling. Do not dispose of the waste product with normal domestic and other wastes at the end of its service life. Take it to the collection center for the recycling of electrical and electronic equipment. Please consult your local authorities to learn about these collection centers.

## 1.3 Compliance with RoHS Directive

The product you have purchased complies with EU RoHS Directive (2011/65/EU). It does not contain harmful and prohibited materials specified in the Directive.

## 1.4 Package information



Packaging materials of the product are manufactured from recyclable materials in accordance with our National Environment Regulations. Do not dispose of the packaging materials together with the domestic or other wastes. Take them to the packaging material collection points designated by the local authorities.

## 2 Your steam station

### 2.1 Overview



1. Lime collecting cartridge
2. Steam station
3. Cable winding slot with bracket
4. Water reservoir removal latch
5. Removable water reservoir
6. Water refill lid
7. Steam station surface
8. Soleplate
9. Transport lock
10. Control panel
11. On/off and control button
12. Steam trigger

### 2.2 Technical data

**Power supply** : 220-240V~, 50-60Hz

**Power consumption** : 2190-2600 W







**Pump pressure** : 6 bar

**Flash steam amount**: Up to 110 g/min.

Technical and design modification rights are reserved.

The values which are declared in the markings affixed on your product or the other printed documents supplied with it represent the values which have been obtained in the laboratories pursuant to the pertinent standards. These values may vary according to the usage of the appliance and ambient conditions.

## 2 Your steam station

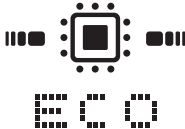
Control panel	Symbols	Descriptions
		Water reservoir is empty
		Steam level
		Lime collecting cartridge should be replaced
		Temperature settings
		Automatic shutdown
		Self-cleaning
		Smart - ECO mode

## 3 Operation

### 3.1 Intended use

This appliance is intended only for household use and ironing; it is not suitable for professional use.

### 3.2 Initial use

1. Remove the package on the lime collecting cartridge (1) which is placed separately in the box.
2. Soak the lime collecting cartridge (1) in the water for 1 minute in order to enhance its performance.

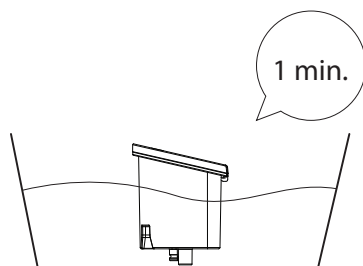

3. Then push the cartridge (1) in its slot.

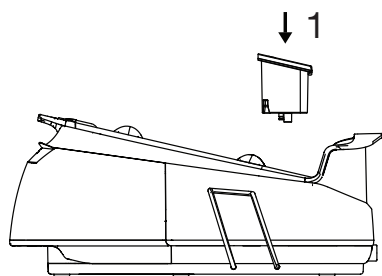

4. Prior to initial use, fill the water reservoir (5) with water (see 3.6) and evaporate the water twice in order to remove the manufacturing residues.



A light odour may arise during the initial use. This condition will return to normal after several uses.

### 3.3 Ironing tips



- The appliance gets heated in a short time; iron fabrics such as synthetic, silk etc. using low temperature settings.
- Iron fabrics that may luster (silk etc.) by turning them inside out or using the appliance in Smart-ECO mode.
- Use very little pressure when ironing fabrics such as velvet and iron them towards one single direction.
- Steam usage may cause stains on coloured silk fabrics. Do not use steam.
- 100% pure woolen clothes can be ironed by using steam.
- Ironing woolen clothes may cause luster. Iron by turning them inside out.



**WARNING:** Do not allow the iron to contact with metal parts such as zippers and rivets. This may damage the soleplate of the iron.

### 3.4 Temperature setting

Set the appropriate temperature for the fabric to be ironed by using the control button (11).

Fabric Type	Temperature Setting	Steam Setting
Synthetic	•	Without steam
Silk-Wool	••	With Steam 
Cotton	•••	With Steam 
Linen - Jean	Max	With Steam 



## 3 Operation



Smart-ECO mode of your appliance is suitable for all types of fabrics that can be ironed. You can iron securely. You can do steam ironing by using the steam trigger (12) in this mode.



**WARNING:** You can do steam ironing at all temperature levels except for "•". Press the steam trigger (12) for steam ironing.



**WARNING:** Take the ironing instructions specified on the label of the fabric into consideration for ironing.

### 3.5 Dry ironing

Your appliance will not raise steam as long as you do not press the steam trigger (12).

In order to use dry ironing, do not press the steam trigger (12).

### 3.6 Filling the water reservoir



**WARNING:** When filling the water reservoir with water without removing the iron from the steam station, ensure that the appliance is unplugged.

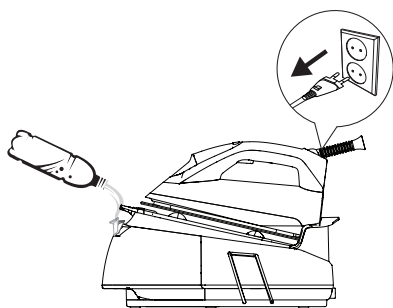

If you press the steam trigger (12) when the water tank is empty, "•" symbol will appear on the screen in about 30-40 seconds.

1. Press the on/off button (11), switch off and unplug the appliance.

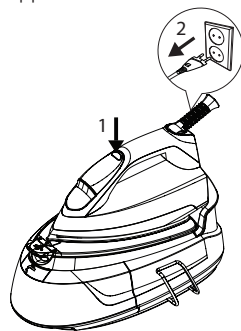

2. Remove the water reservoir (5) by pressing the water reservoir removal latch placed under the water reservoir.

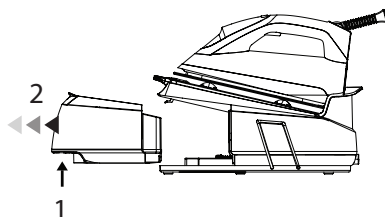

3. Open the water refill lid (6) and fill water up to the MAX level.

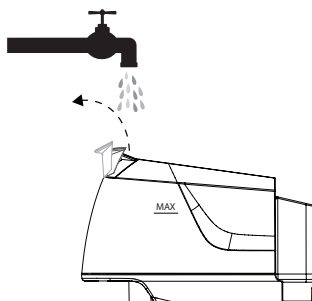

Your appliance is suitable for using with tap water. If your tap water is excessively hard, we recommend you to use a mixture of tap water and potable water.

## 3 Operation

4. Place the water reservoir (5) in its place.
- You will hear a click when the water reservoir fits into its place.

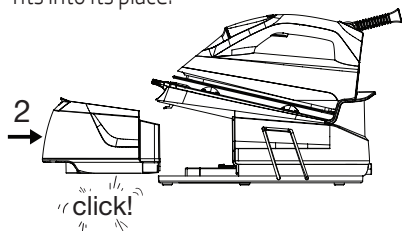

### 3.7 Steam ironing

1. Fill the water reservoir (5) with water (see 3.6).  
2. Place the appliance on the steam station surface (7).  
3. Plug in the appliance.

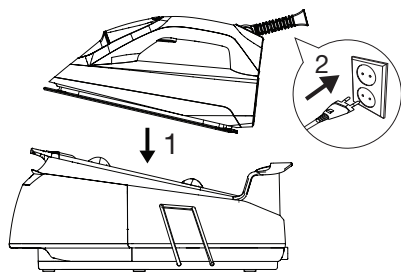

- You will hear a beeping sound when the appliance starts to operate.
  - Control panel (10) flashes once and then goes off.
4. Press the on/off button (11).



Operation of the pump may make some noise during the water drawing process; this is normal.



The appliance starts in Smart-ECO mode in the initial use. This level offers safe temperature and steam amount for all the fabrics that can be ironed.

5. You can set temperature levels other than the Smart - ECO mode by using the control button (11) (see 3.4).



**WARNING:** Your selection should be suited for the fabric to be ironed.

6. When the symbol of the selected setting flashes consistently on the display, your appliance is ready to iron.



**WARNING:** If the symbol on the display blinks, this means that the soleplate temperature setting is not at the desired level.



You can do steam ironing by using the steam trigger (12) at all temperature levels except for "•".

7. When the appliance is ready for steam ironing, move the iron horizontally on the fabric to be ironed and press the steam trigger (12). Your iron will raise steam from its soleplate (8) as long as you hold the steam trigger pressed.

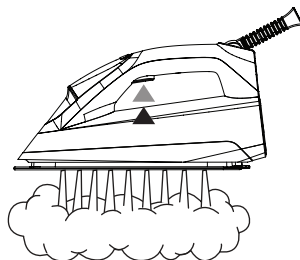

8. When the ironing process is over, press the on/off button (11) for a few seconds.
- The lights on the control panel will go off.
9. Unplug the appliance and leave it to cool.

## 3 Operation

### 3.8 Vertical steam

You can also use the steam in upright position (see 3.7). You can iron your curtains and hanged garments thanks to the vertical steam feature. Keep the appliance 15-30 cm away from the garment and curtains.

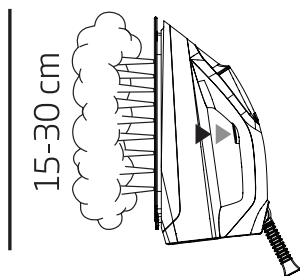

**WARNING:** Never direct the steam to people or pets.

### 3.9 Automatic Shutdown (Auto-Off)

If you do not move the appliance or press any of its buttons for 10 minutes, it will be shut down automatically.

- If you move the appliance horizontally or press any of its buttons, it will start to operate.



It may take 60 seconds for the soleplate (8) to reach the previous temperature level.

## 4 Cleaning and care

### 4.1 Cleaning



**WARNING:** Do not soak the steam station (2) in water or other liquids. Never put vinegar, descaling agent, laundry starch, perfume or other auxiliary products that help ironing into the appliance.



**WARNING:** Do not use gasoline, solvent and abrasive cleaning agents or hard brush to clean the appliance.



**WARNING:** Do not wash your appliance under running water or do not soak it in water or other liquids.



**WARNING:** Do not use abrasive cleaning agents to clean the soleplate (8).

1. Switch off and unplug the appliance before cleaning.
2. Wait for the appliance to cool completely.
3. Use a slightly damp cloth to clean the exterior of the appliance. Then wait for it to dry completely.
4. Wipe the sediments and residues on the soleplate (8) with a slightly damp cloth or with a soft, nonabrasive liquid cleaner if necessary.

1



2



## 4 Cleaning and care

### 4.2 Replacing the lime collecting cartridge



**WARNING:** Do not use any descaling agents! They may damage the appliance.



**WARNING:** Do not purchase cartridge from places other than the dealers and service centers. If you do this, the cartridge will not fit into the cartridge slot and will not operate. This causes a breakdown in your appliance. Faults arising from using wrong cartridge are not covered under warranty.

1. “” symbol will flash on the control panel (10) when the cartridge needs to be replaced.



The cartridge must be replaced after consuming about 30 liters of water.

2. Soak the new cartridge in water for 1 minute in order to enhance its performance.
3. Before removing the old cartridge from its slot, make sure that the sections surrounding the cartridge is cold.
4. Slightly press and release to replace the cartridge.

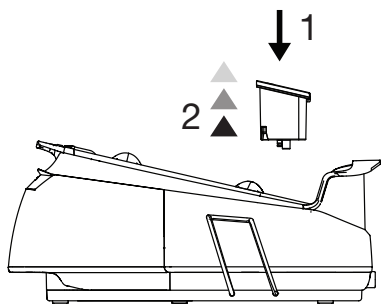



5. Remove the new cartridge from its package, soak it in the water for 1 minute and push it in its slot.

### 4.3 Lime removing feature (Self-Clean)

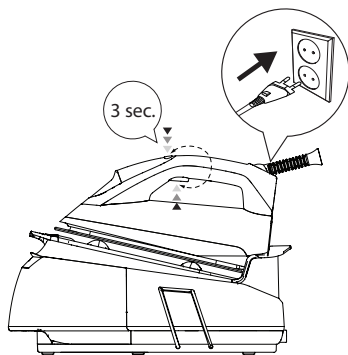
1. When the “” lime removing (self-clean) symbol flashes on the control panel, (10) this means that it is time for lime removing.
2. Fill the water reservoir (5) (see 3.6).
3. Plug in the appliance.
4. Hold and press the control button (11) and steam trigger (12) together for 3 seconds.



The “” symbol will constantly blink on the control panel (10) when the appliance switches to lime removing (self-clean) mode.

5. Then press the control button (11) once.
  - “” symbol will flash on the control panel (10) permanently.
6. Keep the appliance over the sink horizontally and shake it while pressing and holding the steam trigger (12).
7. When the lime removing (self-clean) is over, the appliance automatically returns to the mode before the lime removing process.

## 4 Cleaning and care

### 4.4 Transport lock

1. Turn the transport lock (9) in order to be able to move/transport your appliance easily and store it securely.

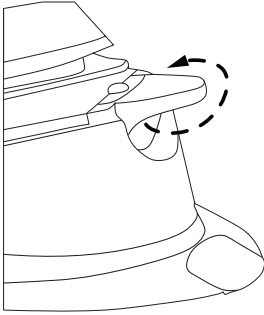

2. Turn the lock again to unlock the transport lock.

### 4.5 Storage

- If you do not intend to use the appliance for a long time, store it carefully.
- Unplug the appliance and wait for it to cool completely before storing it.
- Discharge the water in the water reservoir (5).
- Wrap the cable around the cable winding slot with bracket (3) and fix it in order to store the steam station.

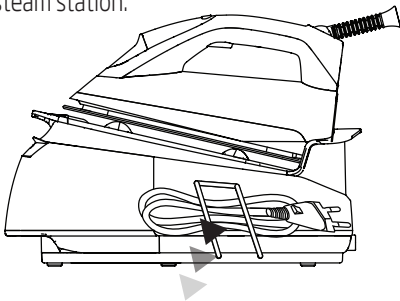

- Store it in a cool and dry place.
- Keep the appliance out of the reach of children.

### 4.6 Moving and transportation

- Carry the appliance in its original packaging during moving and transportation. The packaging of the appliance protects it against physical damages.
- Do not place heavy loads on the appliance or the packaging. The appliance may be damaged.
- Dropping the appliance may render it non-operational or cause permanent damage.